



Serie

Stilo - 60 RPT-L

Especificaciones Técnicas

Carpintería practicable con Rotura de Puente Térmico

Cámara Europea

Junta abierta con Junta Central

Sección de Marco 53 mm.

Sección de Hoja 60 mm.

Galce de vidrio de 10,5 a 54 mm.

Peso Máximo por : Hoja Practicable : 120 Kg.⁽¹⁾

Hoja Oscilo- Batiente : 130 Kg.⁽¹⁾

Hoja Oscilo- Batiente con opción Herraje Oculto

Medidas Máximas por Hoja para todas las aperturas :

1700 mm. x 2500 mm.⁽¹⁾

(1) Consultar rangos de aplicación con nuestro Dpto. Técnico Comercial

Clasificación obtenida

Permeabilidad al aire*	CLASE 4
Estanqueidad al agua*	CLASE E1050
Resistencia al viento*	CLASE C5
Transmitancia térmica**	1,6 W(m ² K)
Aislamiento Acústico***	38 (-1;-5)dB

* Ventana de 2 hojas de 1230 x 1480 mm.

** Ventana de 2 hojas de 1230 x 1480 mm ; Vidrio Uv: 1,0 W(m² K)

*** Ventana de 2 hojas de 1230 x 1480 mm ; Vidrio Rw: 40 (-2,-6)dB

Posibilidades de Apertura

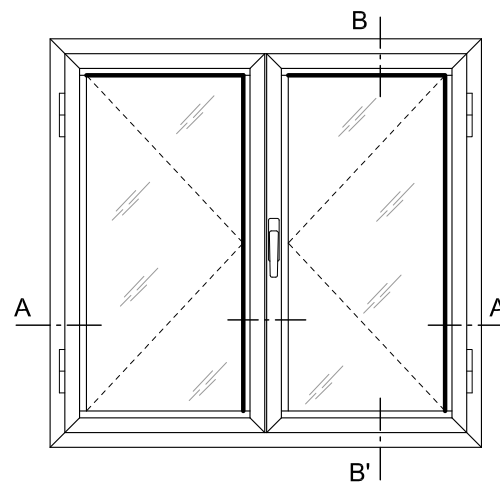
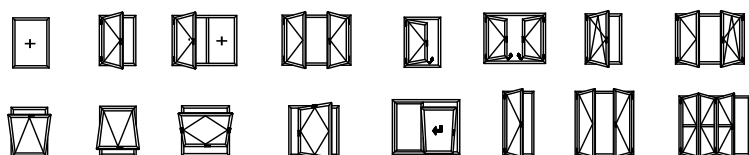

VENTANA 2 HOJAS PRACTICABLES

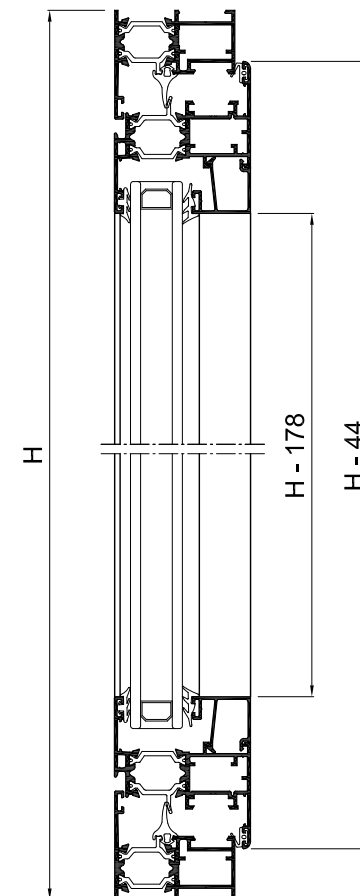

Sección B-B'

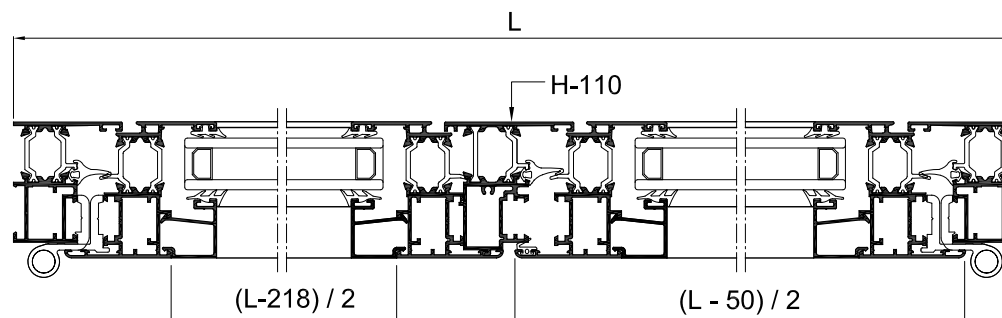

Sección A-A'

* Tabla de Junquillos 1 (Altura 20 mm)

Perfiles

Stilo - 60 RPT-L

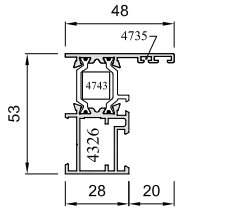

8855L

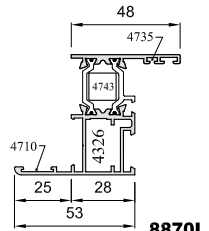

8870L

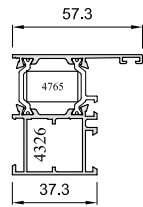

8802L

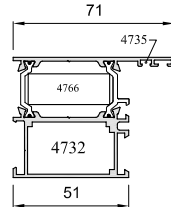

8873L

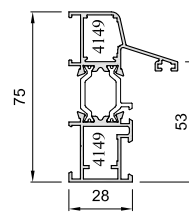

8897L

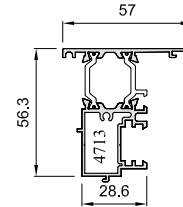

8808L

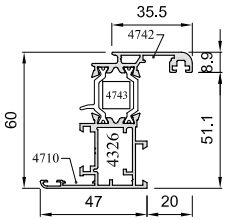

8852L

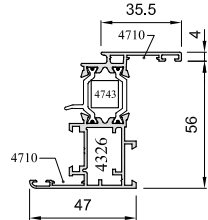

8888L

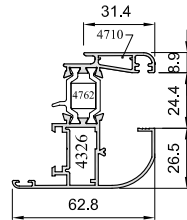

8805L

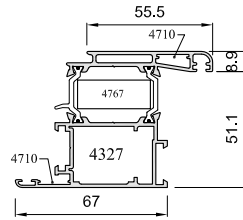

8806L

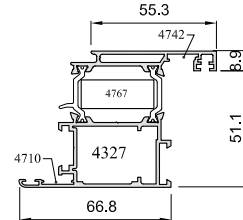

8895L

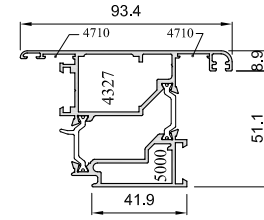

8898L

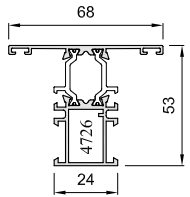

8865L

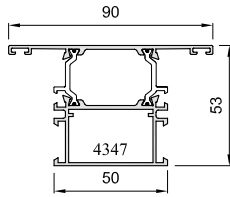

8810L

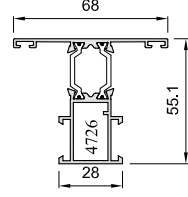

8866L

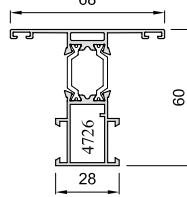

8817L

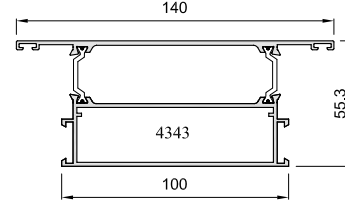

8246L

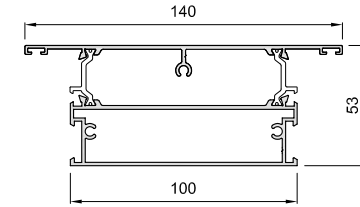

8892L

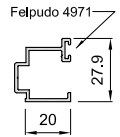

8891

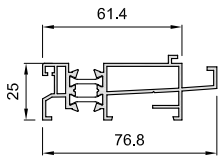

8483M

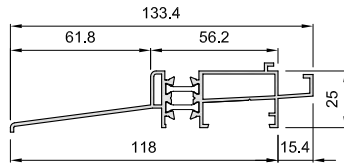

8287M

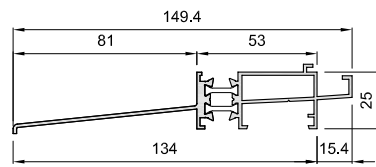

8288M

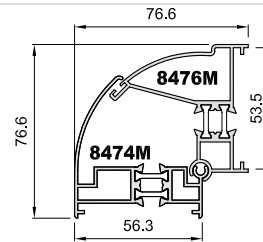

8474M

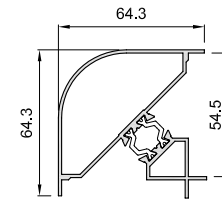

8426M

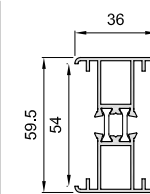

8482M

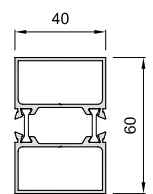

5283M

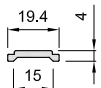

8412

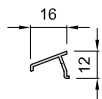

8428

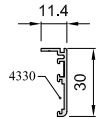

281
1140

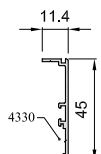

8629

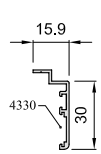

8832

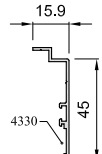

8630



Accesorios

Stilo - 60 RPT-L

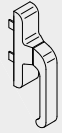

4024
Cremona EURO



4019
Cremona EURO Os-Ba

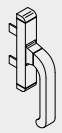

4200
Cremona Nova



4316
Bisagra apertura externa

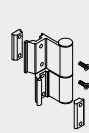

4390
Bisagra regleta Ø 14 mm.



4724
Bisagra Os-Ba Simétrica 2º Hoja



4739
Terminal pletina metálico

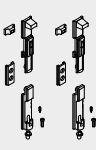

4840
KIT Pasador hoja pasiva metál. (sup. e inf.)

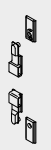

4025
Kit Cremona EURO



4010
Bisagra compás corto ralenti



4085
Bisagra compás largo ralenti



4846
Tercer punto de cierre



4710
Escuadra alineamien. 14 mm.



4735
Escuadra alineamien. 2 mm.



4743
Escuadra intercalaria poliamida



4765
Escuadra intercalaria poliamida



4766
Escuadra intercalaria poliamida



4767
Escuadra intercalaria poliamida



4742
Escuadra alineamiento excéntrica



4327
Escuadra Hoja balconera



4326
Escuadra Cerco y Hoja



4732
Escuadra Cerco balconera



5002
Cierre suplem. entre hojas



4720
Cerradero lateral doble pletina Zamak



4842
Cerradero sup. regulable OS-BA

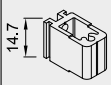

4726
Taco Stilo pilastra 28 mm.

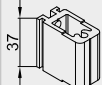

4347
Taco Stilo pilastra ancha



4343
Taco Stilo manguetón

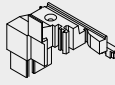

4713
Tapas acople ST-60 RPT-L



4369
Junta central



4055
Junta perim. hoja



4337
Embelle. salida agua c/ membrana



4833
Cremona practicable cover

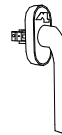

4834
Cremona os-ba Cover



4725
Cremona Prima Os-Ba

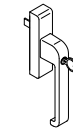

4096
Cremona Os-Pa con llave

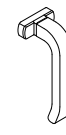

4398
Manilla recuperable

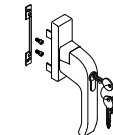

4707
Cremona EURO c/ llave



4723
Cremona Prima

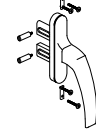

4803
Cremona ap. Ext. patillas Balcon.



1044
Cierre presión (Pequeño)

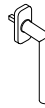

5079
Manilla inox. recta



5080
Manilla inox recta c/llave



5086
Manilla inox recta acodada



4613
Mecanismo Cuadrad. bidirec. practicable



5081
Mecanismo Cuadrad. OS. BA.



4727
Bisagra Flash Izquierda/Derecha

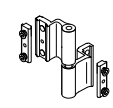

4768
Bisagra 3º Hoja

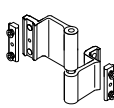

4769
Bisagra Extremo "Jirafa"

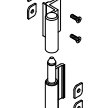

4352
Bisagra ventana 3 hojas

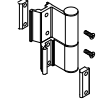

4389
Bisagra regleta Ø 16 mm.

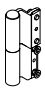

4744
Bisagra Puerta 24,5 mm. Izda.

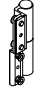

4745
Bisagra Puerta 24,5 mm. Dcha.

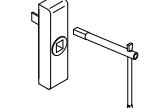

4079
Kit Cremona desmont. OS-Pa > 2000 mm.

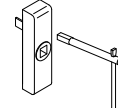

4365
Kit cremona desmont. OS-PA < 2000 mm.



4002
Pasador oculto long. variable



4003
Terminal de pletina cremona

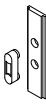

4007
Cierre complem. cre mona



4011
Bisagra compás regul. proyectante

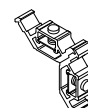

4097
Escuadra acople pivotante



5000
Escuadra Ap.Externa

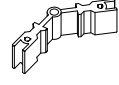

4708
Escuadra ángulo variable



4039
Escuadra inox. alineamiento



4304
Escuadra alineam. solapas



4330
Escuadra alineamien. 15 mm.



4855
Escuadra solapa 8893



4009
Cierre cangrejo Interno



4366
Cierre bisagra oculta



4754
Retenedor de hoja



4848
Microventilación practicable



5026
Bulón regulable



4005
Cerradero lateral pletina Nylon



4004
Cerradero lateral doble pletina Nylon



4078
Pieza sujeción junquillo curvo



4391
Escuadra junquillos curvos



4353
Kit acristalami. s/junquillo



4356
Broca doble diámetro (s/junquillo)



4035
Embellecedor salida agua



4088
Goma perimetral pivotante



4370
Junta central "TC"



4854
Escuadra vulcanizada



4056
Junta perimetral hoja "TC"



4397
Junta Stilo base rígida



4379
Junta acústica cerco



4303
Junta acústica cerco



4741
Goma para batiente



4089
Goma interior acrist. de 2 a 4 mm.



4090
Goma interior acrist. de 4 a 6 mm.



4091
Goma Interior acrist. de 6 a 8 mm.



4057
Goma exterior acristalamiento



4043
Juego tapas condensación



5015
Plantilla escuadra ap.exterior RPT

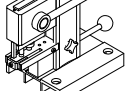

4760
Util manual escuadras intercalarias

Accesorios Varios

- 4025 Kit Cremona EURO
- 4201 Kit Cremona Nova
- 4380 Kit Cremona EURO 2 hojas (sin cremona) 4002x2 + 4003x2 + 4025 + 4004x2 + 4008
- 4714 Kit Cremona EURO 1 hoja 4003x2 + 4025 + 4005x2
- 4300 Cerradura Balconera
- 4373 Cerradura, resbalón y palanca
- 4374 Cerradura seg. 3 puntos, pal. resbal.
- 4715 Cerradura Balconera E=25
- 4335 Ruleta para goma
- 4733 Fresa ST-60 RPT-L
- 4334 Tijeras ingleses goma
- 4393 Util manual (esc. 4097)
- 4062 Util Stilo abatibles
- 4841 Util multiple practicable
- 4845 Fresa Hoja Curva
- 5022 Cremona Industrial Prima
- 5023 Cremona Industrial Euro
- 5024 Herraje Os-Ba Industrial



Perfiles

Stilo - 60 RPT-L

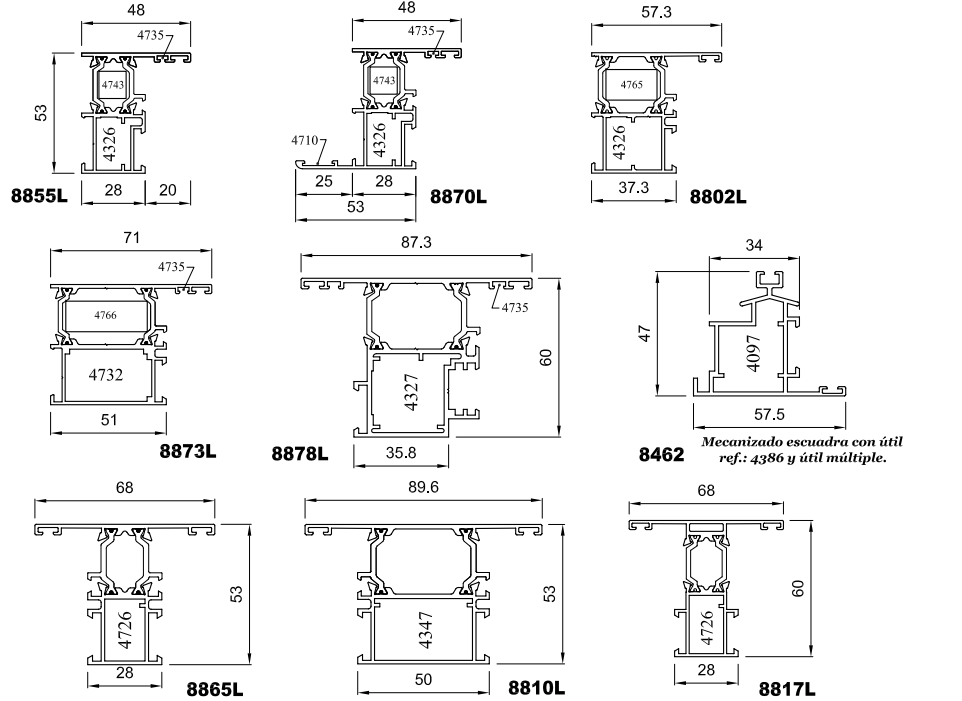

Accesorios

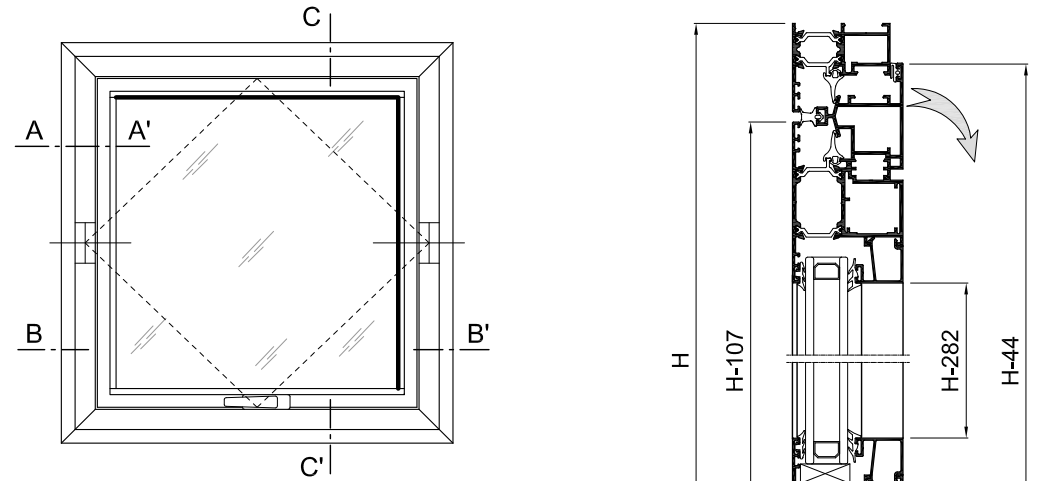

VENTANA BASCULANTE O PIVOTANTE

Sección A-A'

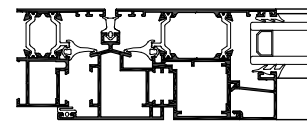

Sección B-B'

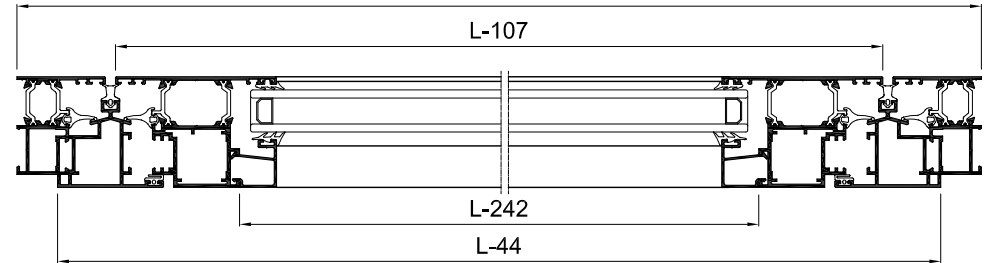

Sección C-C'

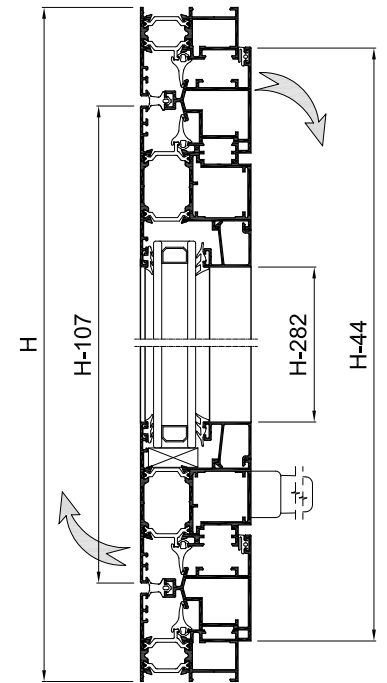

RESISTENCIA	Pivotante HORIZONTAL	
	Peso máximo hoja :	120 Kg.
	Dimensiones máximas (de hoja)	
	altura :	2.200 mm.
	anchura :	1.600 mm.
	Pivotante VERTICAL	
	Peso máximo (por hoja) :	100 Kg.
	Dimensiones máximas (de hoja)	
	altura :	2.200 mm.
	anchura :	1.600 mm.

Accesorios Varios

- 4062 Util Stilo abatibles
- 4841 Util multiple practicable
- 4071 Juego de fresas Stilo 53 mm.
- 4072 Juego de fresas Stilo 63 mm.



Perfiles Stilo - 60 RPT-L

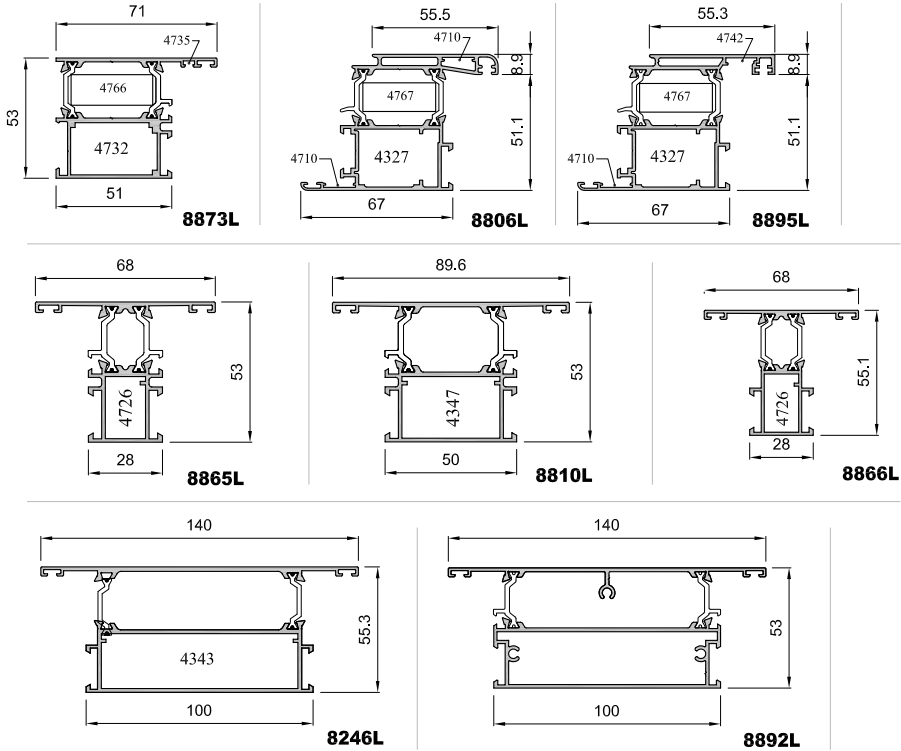

Accesorios

4326 Escuadra Cerro y Hoja	4327 Escuadra Hoja balconera	4732 Escuadra Cerro balconera	4343 Taco Stilo manguetón	4347 Taco Stilo pilastra ancha	4726 Taco Stilo pilastra 28 mm	4091 Goma interior acrist. de 6 a 8 mm.	4090 Goma interior acrist. de 4 a 6 mm.	4089 Goma interior acrist. de 2 a 4 mm.	4057 Goma exterior acristamiento	4369 Junta central	4854 Escuadra vulcanizada	4055 Junta perimetral hoja	4056 Junta perimetral hoja "TC"

4039 Escuadra inox. alineamiento	4710 Escuadra alineamien. 14 mm.	4735 Escuadra alineamien. 2 mm.	4035 Embellecedor salida agua	4337 Embelle. salida agua c/membrana	4707 Cremona EURO c/ llave	4096 Cremona Os-Pa c/ llave	4079 Kit Cremona desmontable Os-Pa mayor de 2000 mm.

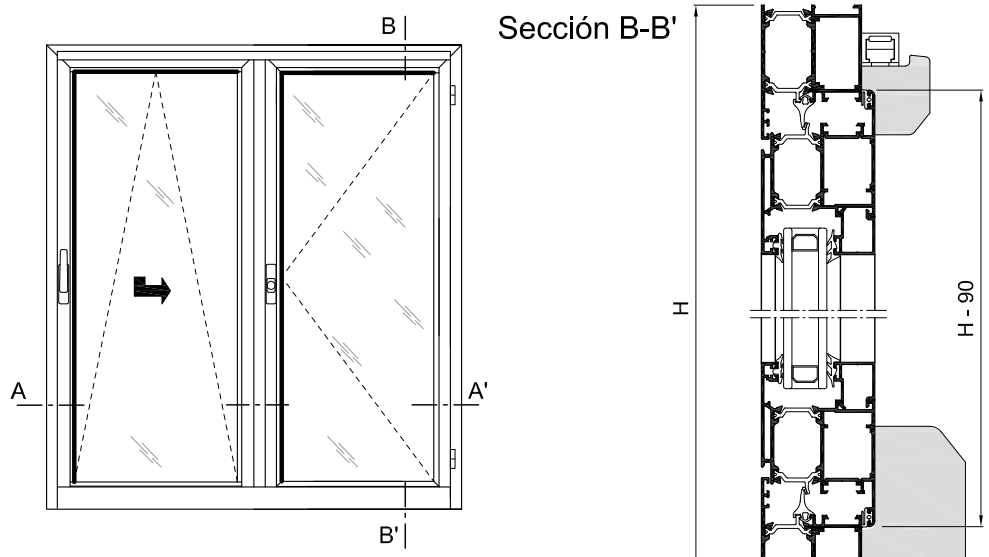

PUERTA OSCILO PARALELA

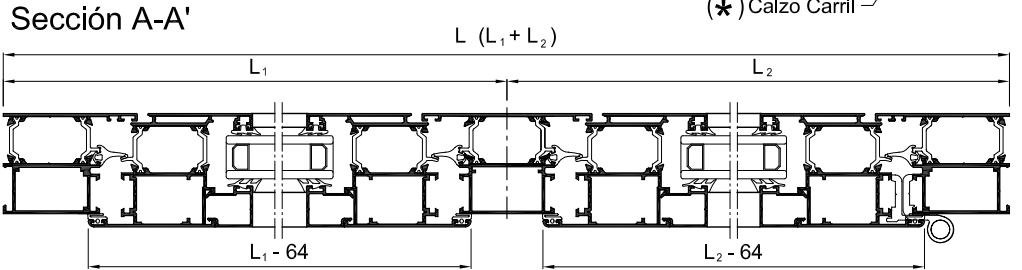

OBSERVACIONES : Para un buen funcionamiento de la Oscilo-Paralela se requiere un perfecto nivelado y aplomado en su colocación y apoyar mediante el calzo (*) el carril en el suelo.

HERRAJE OSCILO-PARALELA

4092	Para long. de hoja de 700 a 900 mm.
4093	Para long. de hoja de 901 a 1100 mm.
4094	Para long. de hoja de 1101 a 1330 mm.
4095	Para long. de hoja de 1331 a 1650 mm.

	Mínimo	Máximo
Longitud de hoja	700	1650
Altura de hoja	850	2400
Peso máximo por hoja	150 Kgs.	

